

AgroMax

DIGITAL LED
CONTROLLER

INSTRUCTIONS

SETTING UP YOUR CONTROLLER



A | AFS-1830 Controller



B | AFS-1830 Remote



C | Probe



D | A/C Power Adapter

The Digital LED Controller from AgroMax can control up to one hundred grow light sources on one easy to use device! Control your light cycle,light intensity and program automatic dimming or shut-down with high-temperature settings!

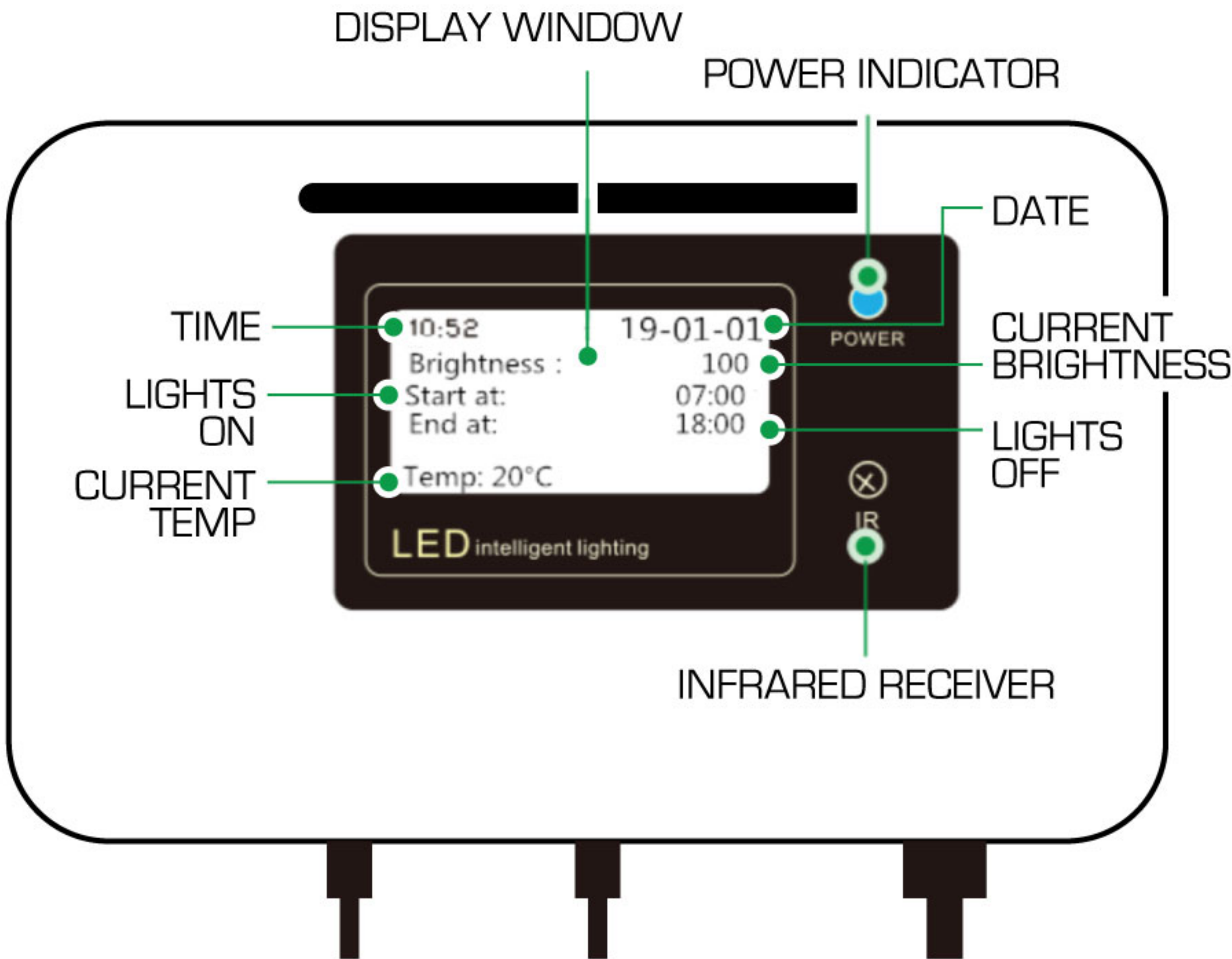
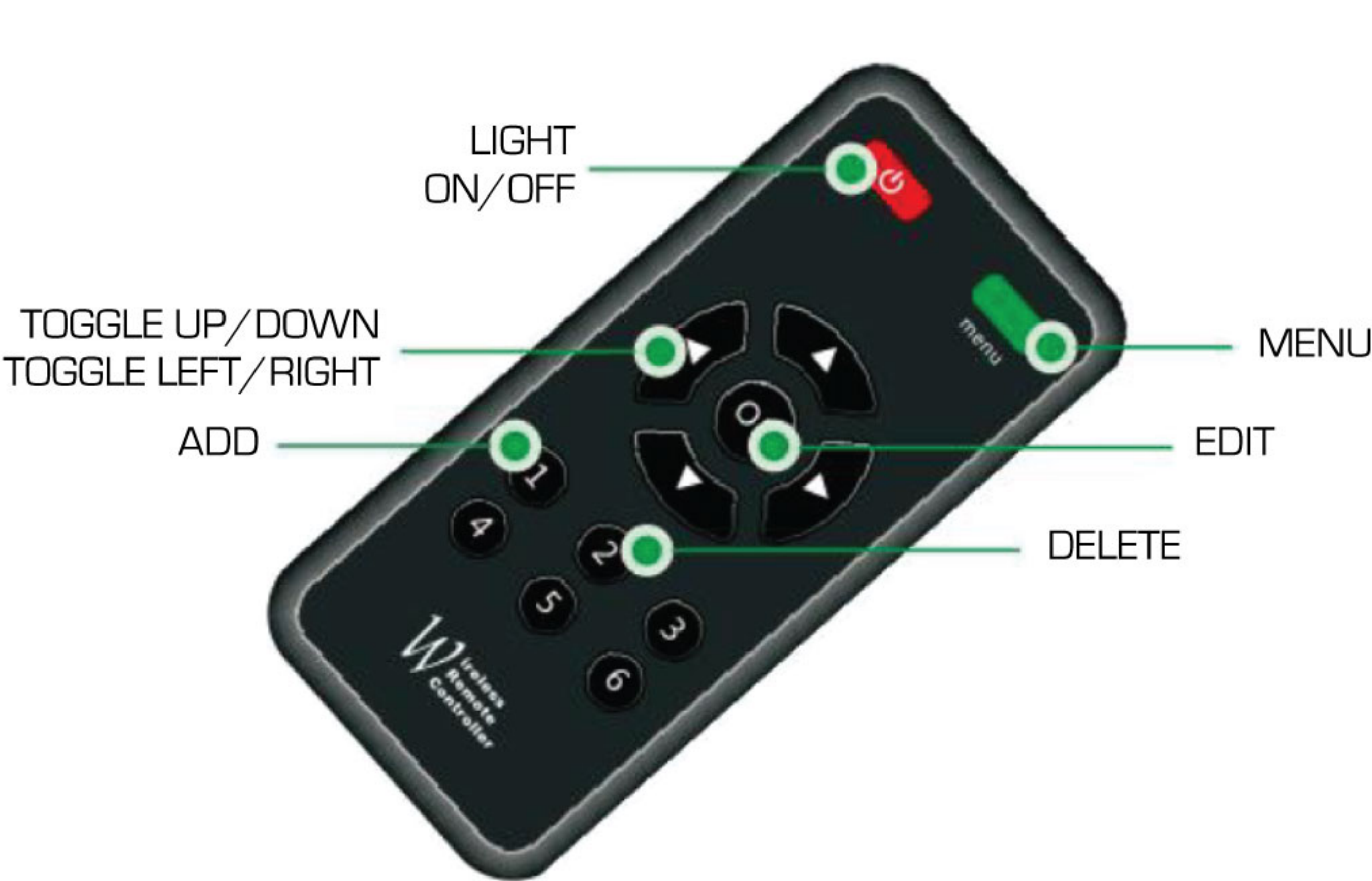

The AgroMax Digital LED Controller operates with these main functions:

- LIGHT CYCLE** : Sets the time your light sources are on and off
- SUNRISE/SUNSET** : Programs gradual brightening/dimming to mimic the natural sunrise and sunset.
- DIMMING** : Adjusts the light output of grow lights (if compatible) during the ON period (Sunny) and even during the OFF period (Moon).
- AUTOMATIC DIMMING** : Sets dimming to control light output based on a specific high temperature. Lighting will dim automatically if the high-temperature is surpassed, and return to full brightness automatically once temperature drops below the set point.
- AUTOMATIC SHUT-OFF** : Turns lighting off if the temperature exceeds a set limit.

RED BUTTON: ON/OFF	Use to turn controller on and off
GREEN BUTTON: Menu	Use to navigate to FUNCTIONS screen
LEFT/RIGHT ARROWS	Use to navigate between fields
UP/DOWN ARROWS	Use to edit fields and values
OK BUTTON	Use to select a FUNCTION

IMPORTANT: The smart controller panel can only be operated via the remote controller. Please keep the remote controller close to the smart controller panel. The included remote controller is used to operate the controller.

AgroMax DIGITAL LED CONTROLLER INSTRUCTIONS

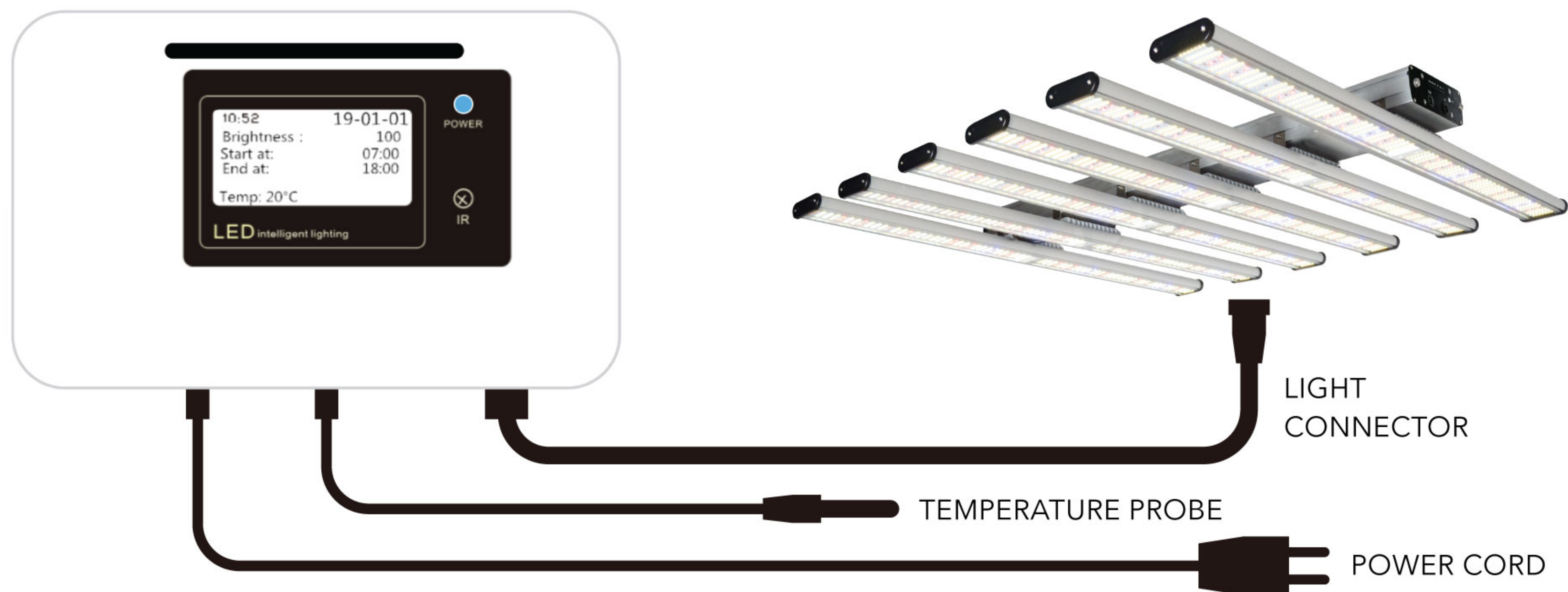

INSTALLATION

- Mount the controller to a wall or surface using the built-in wall-mount plate on the back of the unit.
- Connect the temperature probe into receptacle of controller unit and hang temperature probe in the garden canopy. Keep the probe away from radiant heat, including light sources, to ensure accurate temperature control.
- Connect the controller to the light source using the Light Connector cord.
- Connect the Light Connector cord to the INPUT receptacle of the first or "master" light.
- Connect additional light fixtures to the master light using the Light Connector cords. The master light OUTPUT receptacle should be connected to the second light INPUT receptacle. Repeat, connecting the second light OUTPUT receptacle to the third light INPUT and so on using Light Connector cords.

NOTE: Your light fixtures will each need to be energized by the appropriate power source. The Digital LED Controller and master light do not supply energy to operate additional lights. The Digital LED Controller only controls output across multiple lights. It does not power multiple lighting systems.

After all lighting units have been connected via Light Connector cords, connect the A/C power adapter to the controller and plug in to a standard 120v receptacle to power on the system. When powered on, the controller will automatically run a quick self-test that will momentarily dim lights from 0 (off) to 100 and back to 0 (off).

SETTINGS:

Use the included remote control to program the Digital LED Controller. To begin, remove the battery protector tab from the remote control. Point the remote control at the IR sensor on the face of Digital LED Controller. Use left/right toggle buttons to switch between values, and up/down toggle buttons to change the values.

NOTE: The remote control utilizes a 2025 Lithium battery. If unable to program the Digital LED Controller please try a new battery in the remote control.

AgroMax DIGITAL LED CONTROLLER INSTRUCTIONS



SYSTEM SETTINGS

- Press the GREEN Menu Button
- Use the toggle buttons to navigate to "System"
- Press OK to go to System Settings

CONFIGURE THE FOLLOWING:

DATE: Using the toggle buttons, set the year, month and date.

CLOCK: Set the correct time using the toggle buttons. Note: Time is set in military time (24-hour clock).

LCD CONTRAST: Adjust the LCD screen brightness as desired.

FACTORY DEFAULT: Leave setting as "NO" to allow for programming of the unit.

Note: The unit will revert to the home screen after approximately 30 seconds of inactivity. All settings will run as programmed.

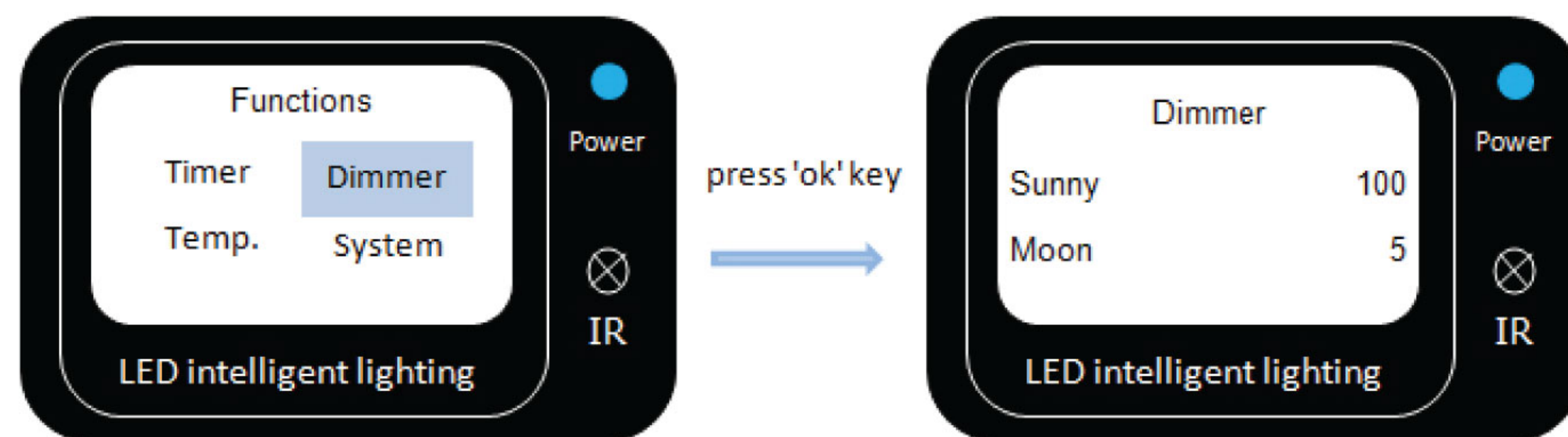

DIMMER SETTINGS:

- Press the GREEN Menu Button
- Use the toggle buttons to navigate to "Dimmer"
- Press OK to go to Dimmer Settings

CONFIGURE THE FOLLOWING:

SUNNY: This function sets the base light output level of the system for the daylight (lights-on) period. Use the toggle button to select the desired value. For normal plant growth, set to 100 or full output. If a lower output setting is desired, set the output value accordingly.

MOON: This function sets the base light output level of the system for the dark (lights-off) period. Use the toggle button to select the desired value. The MOON function will provide light output unless set to 0 (off). **Set MOON output to 0 to turn the light off completely during the dark period.**

IMPORTANT: Set the MOON to 0 for proper plant growth of most common plants. The function is for specialty plants only and not recommended for general use.

AgroMax DIGITAL LED CONTROLLER INSTRUCTIONS



We recommend a 1-minute sunrise and sunset.
For vegetative plants, an ON/OFF time of 18/6 is ideal for growth.
For flowering plants, an ON/OFF cycle of 12/12 is ideal.

EXAMPLE: 18 Hours of Light from 5 AM to 11 PM
Sunny: 100 Moon: 0 Sunrise: 04:59-05:00 Sunset: 22:59-23:00

LIGHT CYCLE SETTINGS:

- Press the GREEN Menu Button
- Use the toggle buttons to navigate to "Timer"
- Press OK to go to Timer Settings

CONFIGURE THE FOLLOWING:

SUNRISE (Lights On): This function gradually increases output to the preset SUNNY or daylight brightness at the beginning of the light cycle just as a natural sunrise would. Use the toggle buttons to set the duration of SUNRISE or the length of time from 0 to SUNNY output.

SUNSET (Lights Off): This function gradually decreases output to the preset MOON or lights-off output level at the end of the light cycle. The time the SUNSET period ends is the completion of the daylight part of the photoperiod and when the MOON or lights-off period begins. Use the toggle buttons to set the duration of SUNSET or the length of time from SUNNY to 0 output.

NOTE: The "lights-on" period will begin at the start of Sunrise and conclude at the end of Sunset. Remember to observe military time (24-hour clock) when setting times [Time > 12:00 = p.m.]

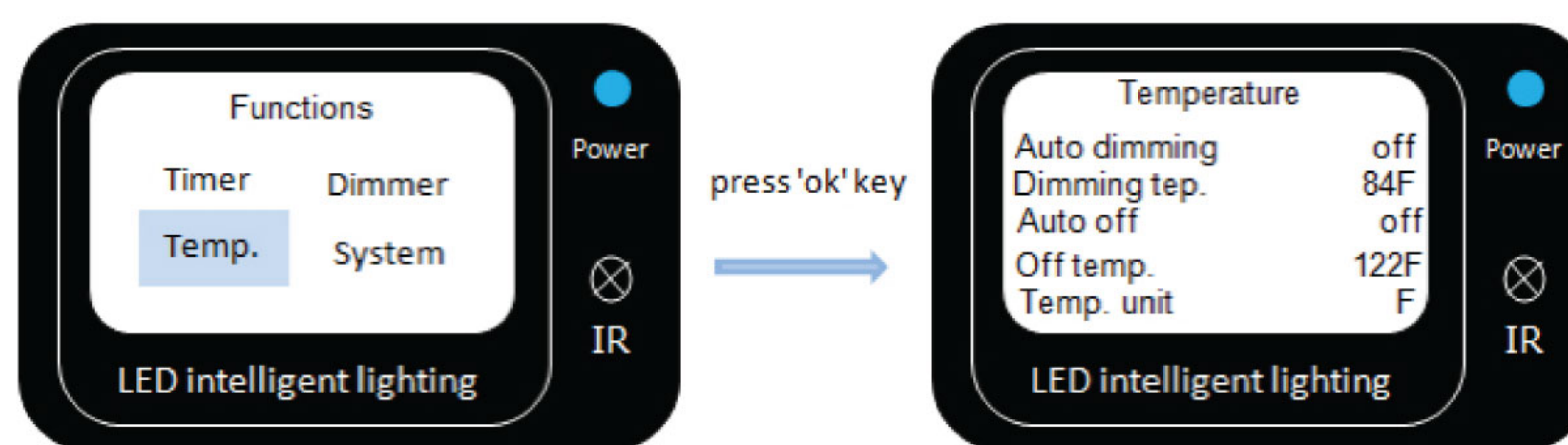

TEMPERATURE SETTINGS:

- Press the GREEN Menu Button
- Use the toggle buttons to navigate to "Temp"
- Press OK to go to Temperature Settings

CONFIGURE THE FOLLOWING:

AUTO-DIMMING: This function automatically dims lighting based on the Dimming Temp. setting. Once the dimming temperature is exceeded, the controller will automatically begin to dim the lights. The temperature is registered by the included temperature probe. The probe should be placed near the garden canopy to best measure the temperature. Use the toggle up/down button to change the value for Autodimming ON or OFF.

SET TO "ON": Proceed to toggle Dimming Temp. Use the toggle up/down to set the temperature that will initiate autodimming.

AUTO OFF: This function will automatically turn off the light sources when the set Off Temp. is exceeded.

Use the toggle up/down button to change the value for Auto Off ON or OFF

SET TO "ON": Proceed to toggle Off Temp. Use the toggle up/down to set the temperature that will initiate lights-off.

TEMP. UNIT: This function changes the temperature display to Celsius (C) or Fahrenheit (F). Use the up/down toggle buttons to set the desired unit reading.