

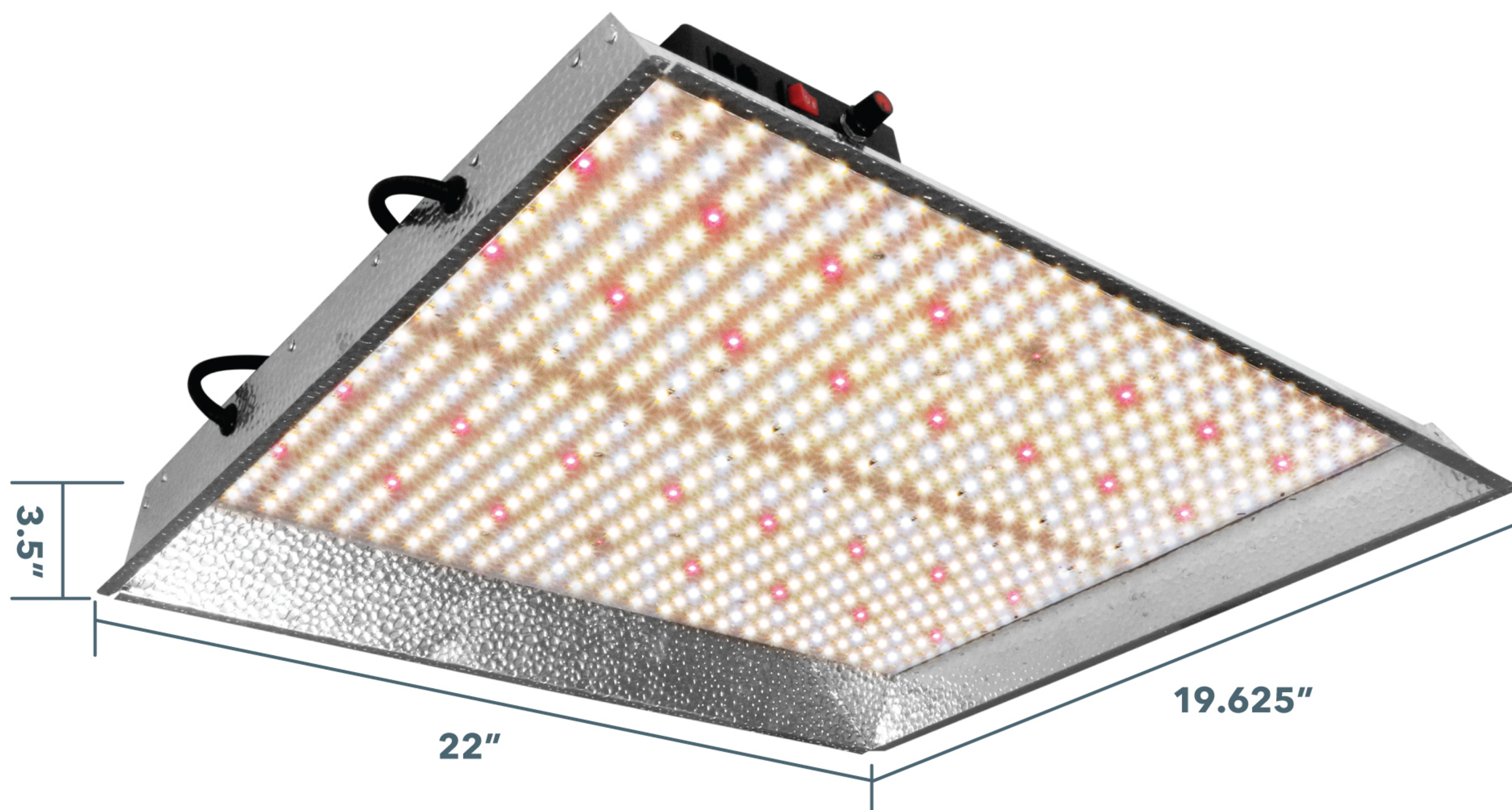

# DIGITAL GREENHOUSE

## HS-2000 FULL SPECTRUM LED GROW LIGHT



### SPECIFICATIONS

**Dimensions:** 22" x 19.625" x 3.5"

**Input Current (Amps):** 1.08 (277v) | 1.25 (240v) | 2.5 (120v)

**Input Voltage:** 120-277v multi-volt

**Power Draw:** 300w

**PPFD:** 632.4 $\mu$ mol @ 18" avg.

**Lifespan:** 50,000+ Hours

**Chip Count:** 672 Diodes

- Full-Spectrum 3000K (512 Diodes)
- Full-Spectrum 5000K (128 Diodes)
- 660nm Horticultural Red (30 Diodes)

### FEATURES

- High-efficiency SMD LED chips
- Enhanced horticultural full-spectrum for full-cycle growing
- Integrated four-sided reflector
- Conformal coating to protect the system from dust/moisture

### Included:

- Fixture
- Hanging Hardware
- Rope Ratchet Hanger
- System Information & Instruction Sheet

### INSTALLATION



**1** Attach 4 hanging hardware clips to the driver mounting bracket.

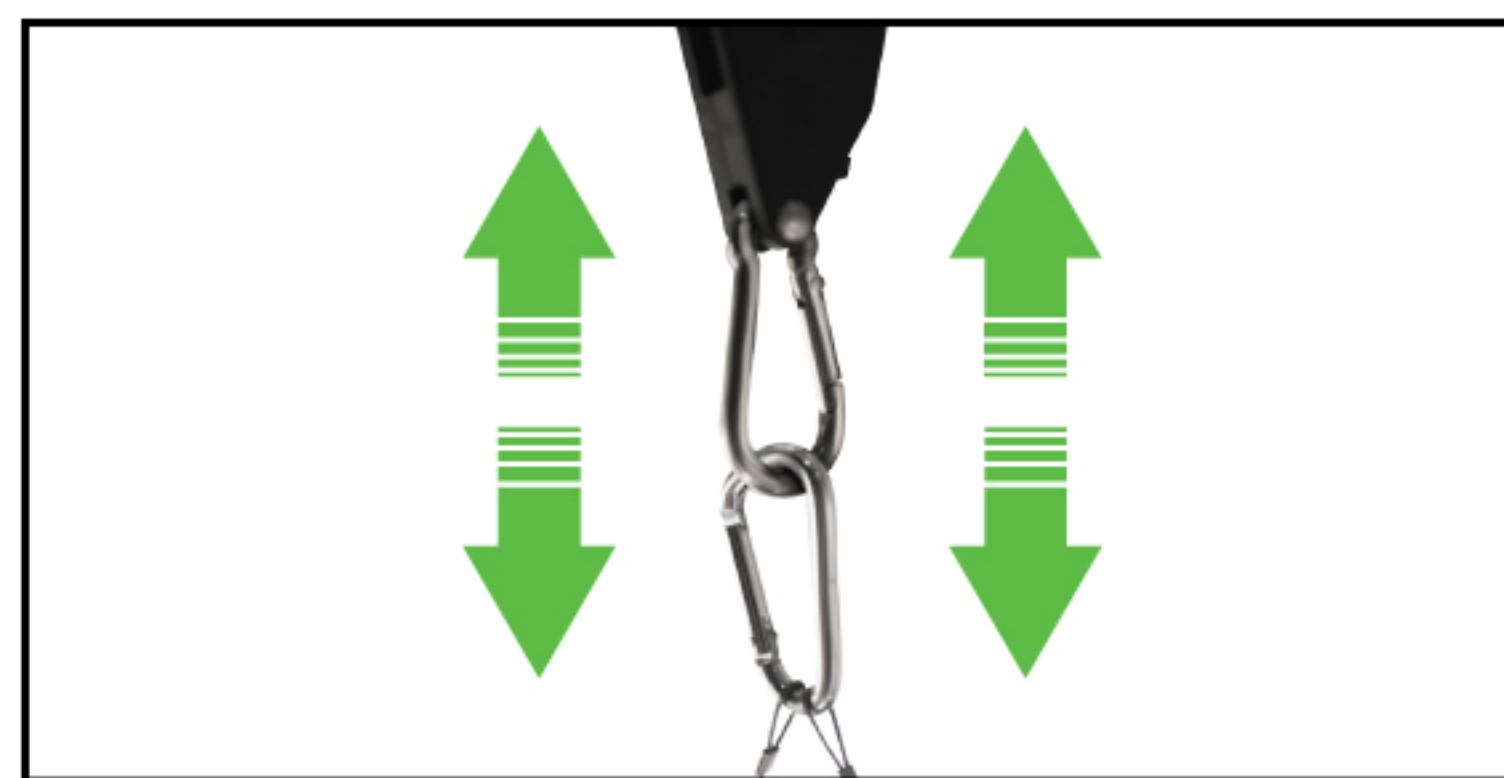

**2** Attach non-ratchet carabiner to mounting point, then attach ratchet carabiner to hanging harness carabiner and adjust height as needed (optional).

*Refer to Operation Recommendations.*

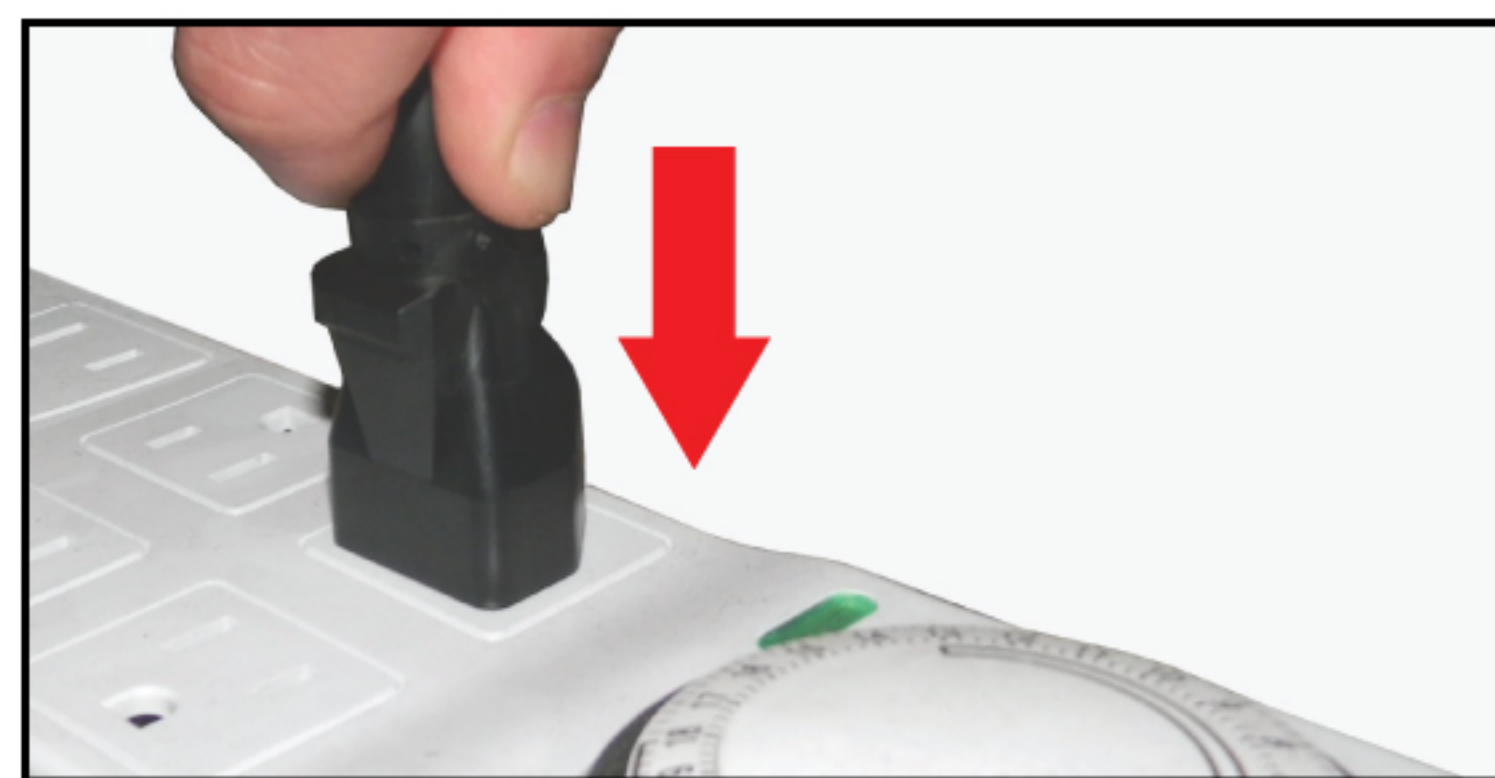

**3** Plug the fixture into your power source.



**4** Adjust output as desired using built-in dimming controls





# DIGITAL GREENHOUSE

## HS-2000 FULL SPECTRUM LED GROW LIGHT

### OPERATION RECOMMENDATIONS

#### Light Coverage and Hanging Height Recommendations

Coverage and canopy light intensity levels can be adjusted by simply raising or lowering the light (additional hanging equipment may be required). For best results, position the light between 18" and 24" above the plant canopy according to the plant growth stage:

24" Above canopy | lower canopy intensity, best for seedlings & young vegetative plants | up to 4' x 4' coverage

18" Above canopy | higher canopy intensity, best for flowering plants | up to 3' x 3' coverage

#### 24" ABOVE CANOPY



#### 18" ABOVE CANOPY

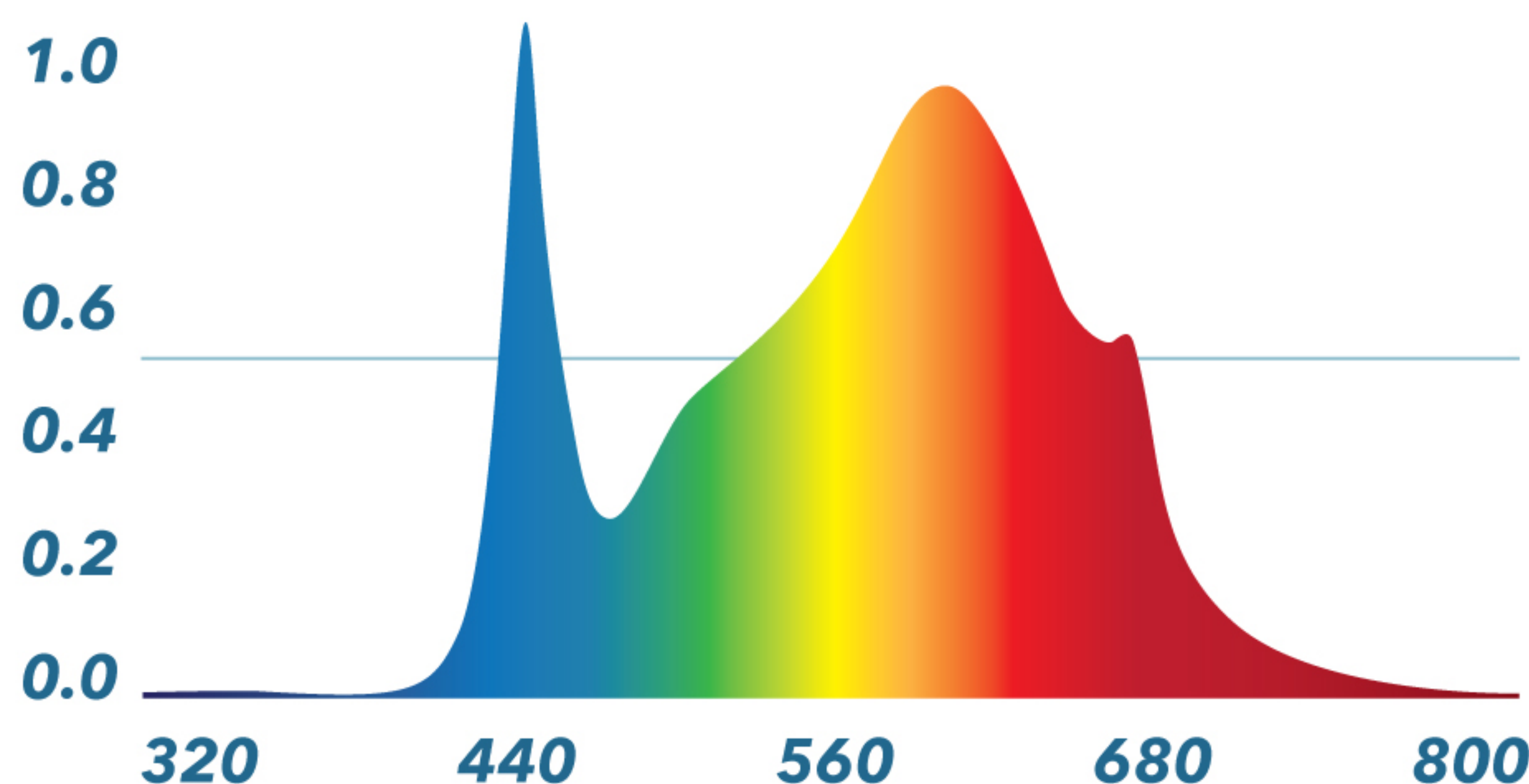

253	366	457	474	446	369	256
440	742	1021	1121	1033	745	437
476	811	1148	1265	1140	816	483
443	738	1035	1122	1027	735	441
351	552	750	800	755	555	346
254	363	451	478	456	358	251

<399 PPFD

400-699 PPFD

700-999 PPFD

>1000 PPFD

### LIGHTING CYCLE TIPS

Lighting cycles (lights-on/lights-off durations) are essential for achieving proper growth and good production. While optimal light cycles can vary among plant species/strains, the following general 24-hour schedules will work great for most plants:

#### VEGETATIVE STAGE

ON: 18HR

OFF: 6HR

Seedlings & Vegetative-Stage plants: 18 hours lights-on, 6 hours lights-off - simulates longer daylight periods of spring/summer to maximize vegetative growth.

#### FLOWERING STAGE

ON: 12HR

OFF: 12HR

Flowering-Stage Plants: 12 hours lights-on, 12 hours lights-off - simulates shorter daylight periods of late-summer/autumn to encourage flower growth and development.

### SAFETY INFORMATION

- Intended for indoor use only.
- Do not operate in extreme heat or cold conditions
- Caution: To protect eyes, do not look directly at LEDs
- Disconnect from power source before handling
- Caution: Driver may be hot to the touch. Use appropriate protective gloves or allow to cool before handling.