

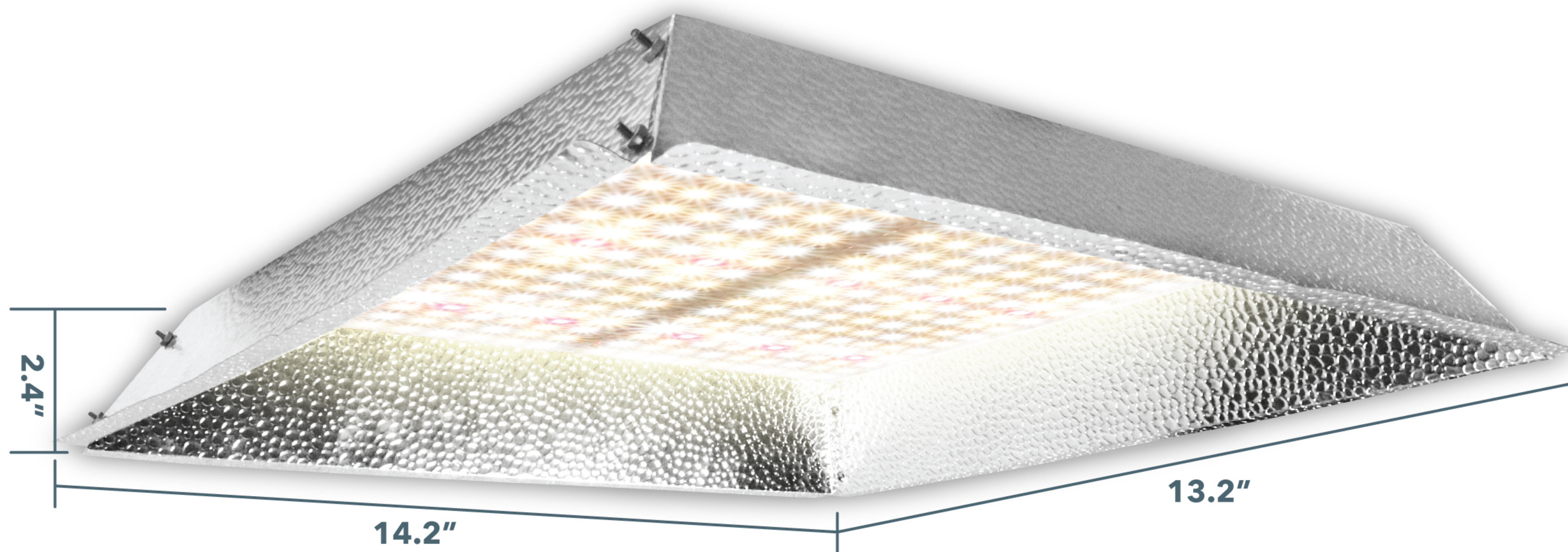

DIGITAL GREENHOUSE

HS-1000 FULL SPECTRUM LED GROW LIGHT



SPECIFICATIONS

Dimensions: 14.2" x 13.2" x 2.4"

Input Current (Amps): .625 (240v) - 1.25 (120v)

Input Voltage: 120-240v multi-volt

Power Draw: 150w

PPFD: 454.9 μ mol @ 18" avg.

Lifespan: 50,000+ Hours

Chip Count: 342 Diodes

- Full-Spectrum 3000K (216 Diodes)
- Full-Spectrum 5000K (108 Diodes)
- 660nm Horticultural Red (18 Diodes)

FEATURES

- High-efficiency SMD LED chips
- Enhanced horticultural full-spectrum for full-cycle growing
- Integrated four-sided reflector
- Multi-volt driver operates on 110-277v power

Included:

Fixture
Hanging Hardware
System Information & Instruction Sheet

INSTALLATION



1 Attach hanging hardware clips to the driver mounting bracket.

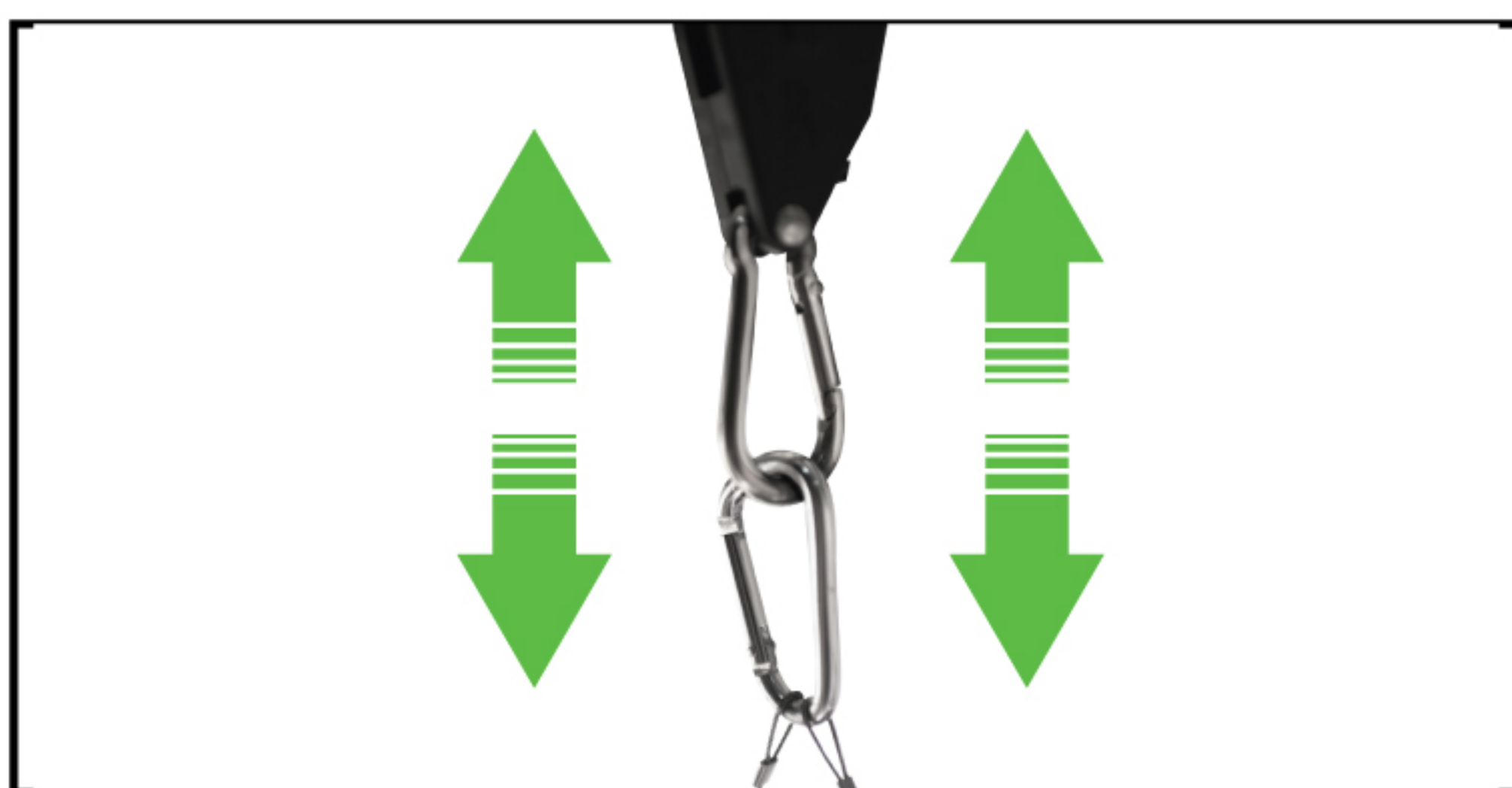

2 Position the fixture and adjust height as needed (refer to operation recommendations).

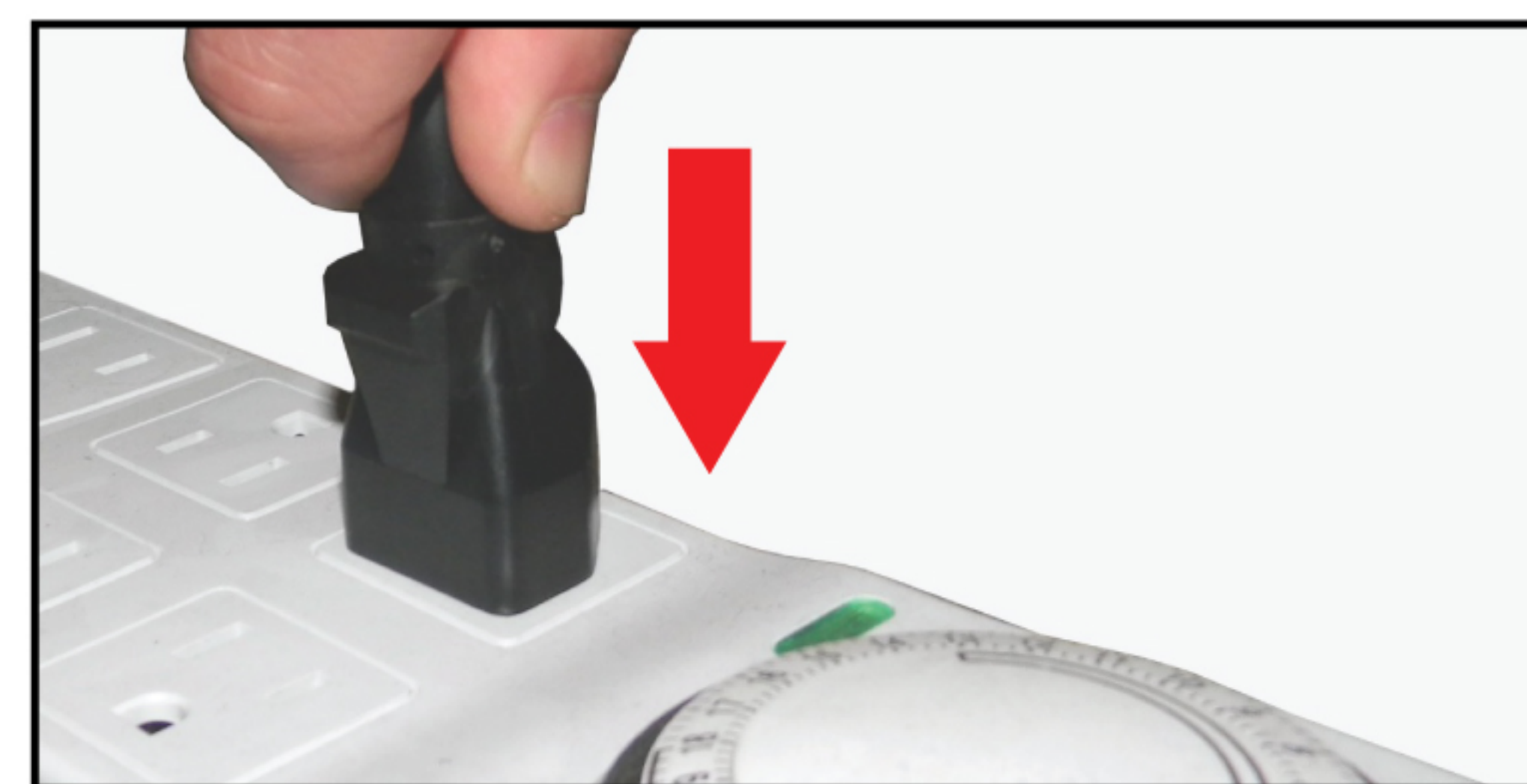

3 Plug the fixture into your power source and start growing!



DIGITAL GREENHOUSE

HS-1000 FULL SPECTRUM LED GROW LIGHT

OPERATION RECOMMENDATIONS

Light Coverage and Hanging Height Recommendations

Coverage and canopy light intensity levels can be adjusted by simply raising or lowering the light (additional hanging equipment may be required). For best results, position the light between 12" and 16" above the plant canopy according to the plant growth stage:

16" above canopy | lower canopy intensity, best for seedlings & young vegetative plants | up to 3' x 3' coverage

12" above canopy | higher canopy intensity, best for flowering plants | up to 2.5' x 2.5' coverage

16" ABOVE CANOPY



12" ABOVE CANOPY



LIGHTING CYCLE TIPS

Lighting cycles (lights-on/lights-off durations) are essential for achieving proper growth and good production. While optimal light cycles can vary among plant species/strains, the following general 24-hour schedules will work great for most plants:

VEGETATIVE STAGE

ON: 18HR

OFF: 6HR

Seedlings & Vegetative-Stage plants: 18 hours lights-on, 6 hours lights-off - simulates longer daylight periods of spring/summer to maximize vegetative growth.

FLOWERING STAGE

ON: 12HR

OFF: 12HR

Flowering-Stage Plants: 12 hours lights-on, 12 hours lights-off - simulates shorter daylight periods of late-summer/autumn to encourage flower growth and development.

SAFETY INFORMATION

Intended for indoor use only.

Do not operate in extreme heat or cold conditions

Caution: To protect eyes, do not look directly at LEDs

Disconnect from power source before handling

Caution: Driver may be hot to the touch. Use appropriate protective gloves or allow to cool before handling.

PLEASE NOTE: DO NOT REMOVE BLUE CAP ON LED DRIVER. WILL VOID WARRANTY.