

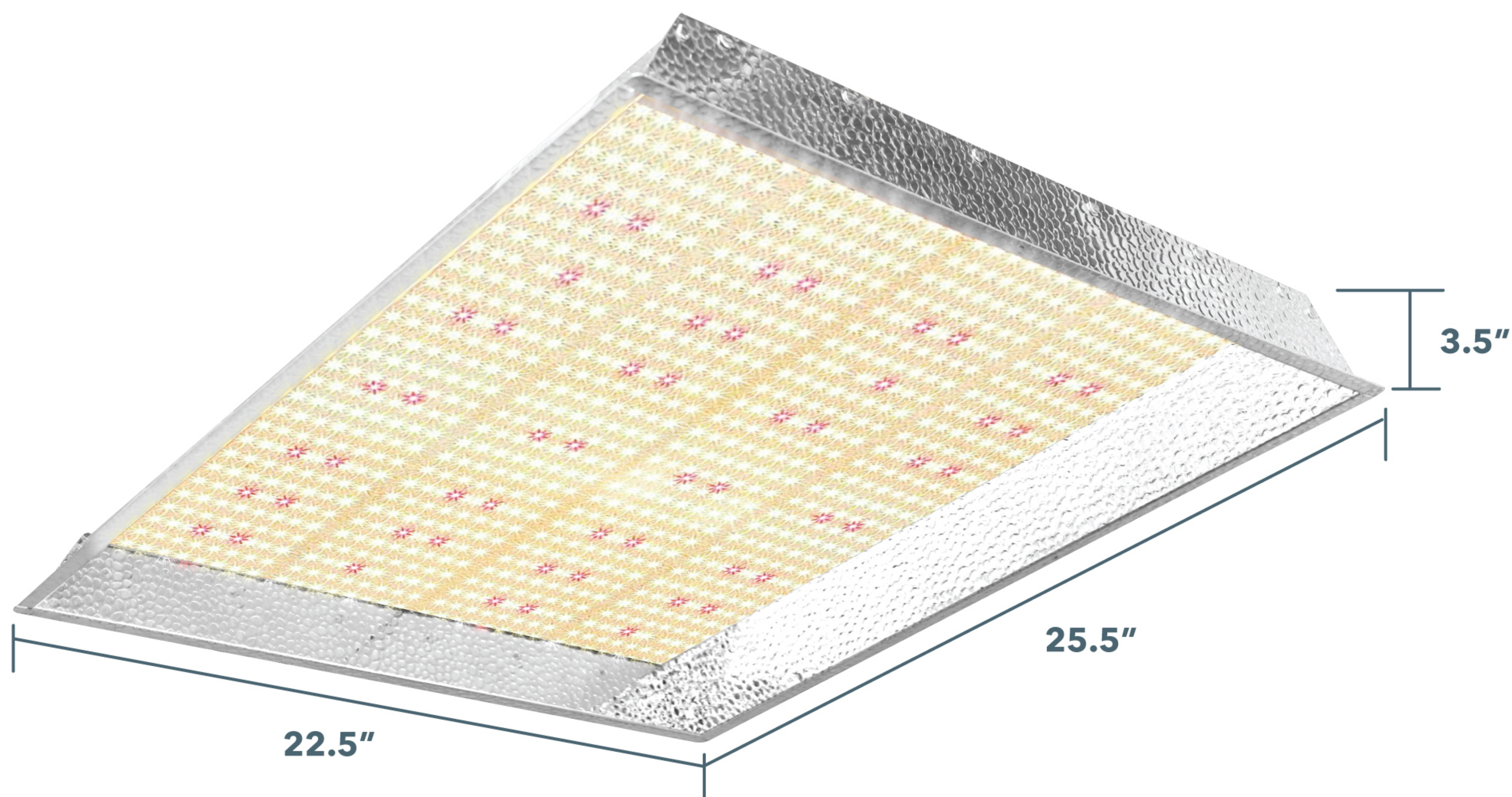

DIGITAL GREENHOUSE

HS-3000 FULL SPECTRUM LED GROW LIGHT



SPECIFICATIONS

Dimensions: 25.5" x 22.5" x 3.5"

Input Current (Amps): 1.6 (277v) | 1.8 (240v) | 3.75 (120v)

Input Voltage: 120-277v multi-volt

Power Draw: 450w

PPFD: 760.25 μ mol @ 18" avg.

Lifespan: 50,000+ Hours

Chip Count: 904 Diodes

- Full-Spectrum 3000K (540 Diodes)
- Full-Spectrum 5000K (300 Diodes)
- 660nm Horticultural Red (60 Diodes)
- 730nm Far Red (4 Diodes)

FEATURES

- High-efficiency SMD LED chips
- Enhanced horticultural full-spectrum for full-cycle growing
- Integrated four-sided reflector
- Conformal coating to protect the system from dust/moisture

Included:

- Fixture
- Hanging Hardware
- Rope Ratchet Hanger
- System Information & Instruction Sheet

INSTALLATION



1 Attach 4 hanging hardware clips to the driver mounting bracket.

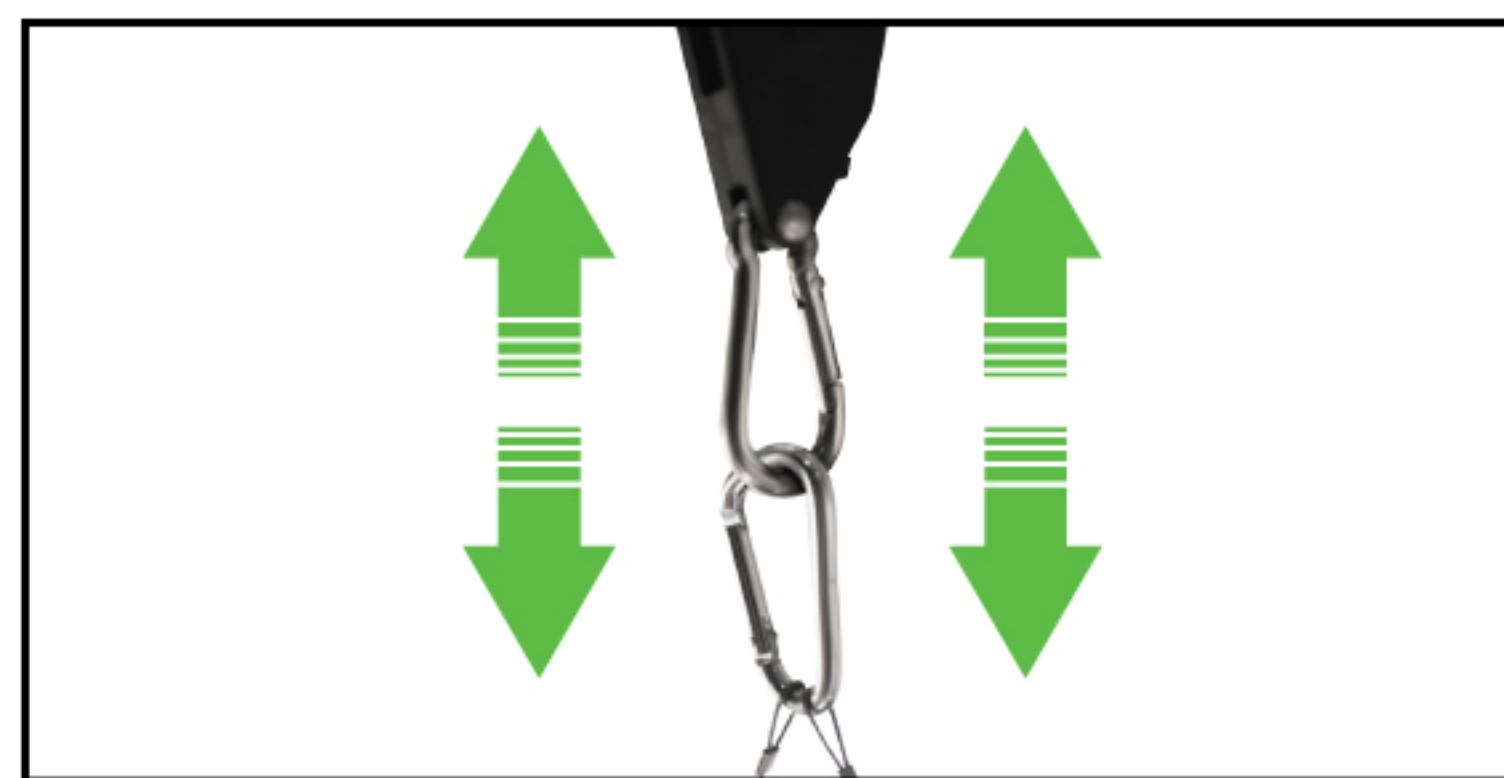

2 Attach non-ratchet carabiner to mounting point, then attach ratchet carabiner to hanging harness carabiner and adjust height as needed (optional).

Refer to Operation Recommendations.

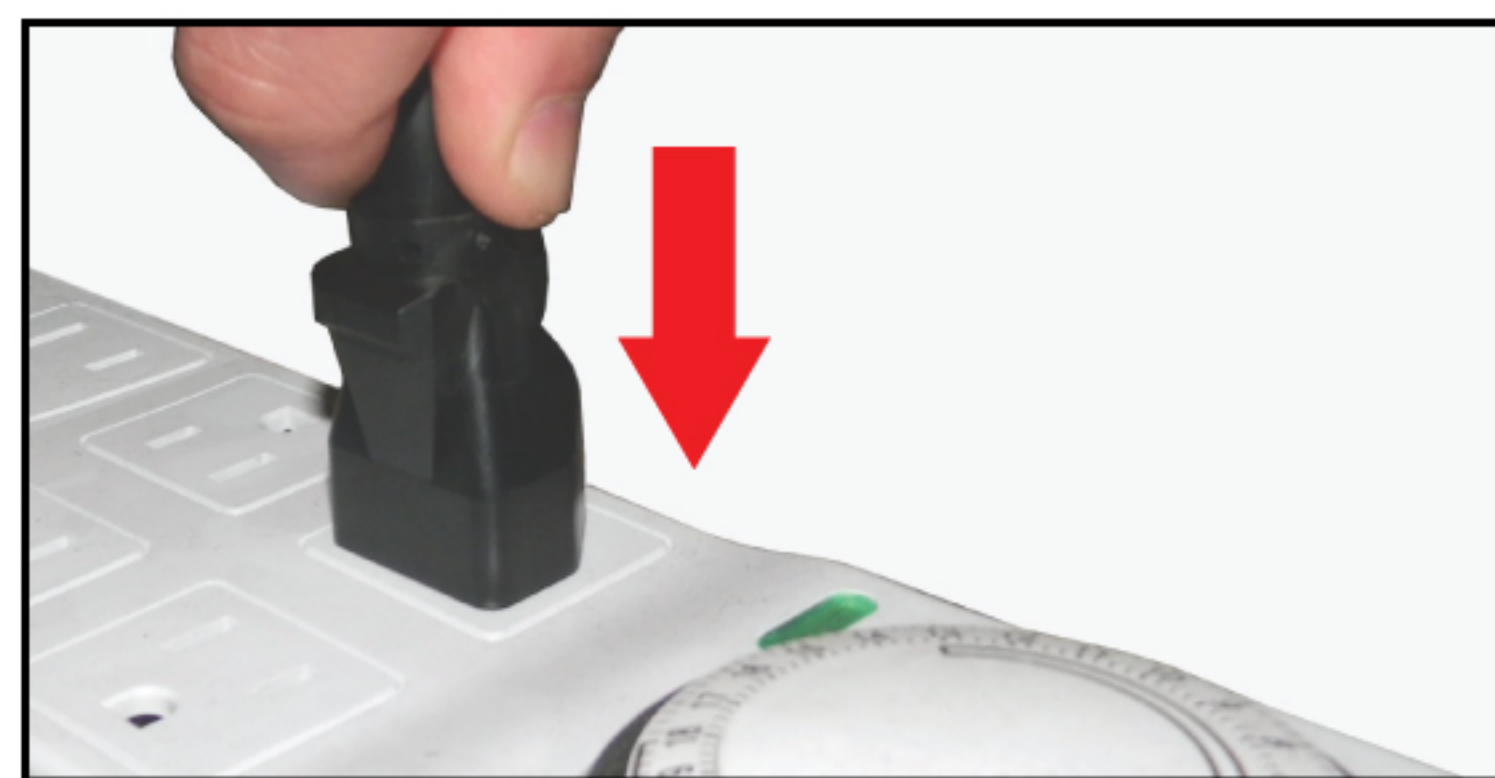

3 Plug the fixture into your power source.



4 Adjust output as desired using built-in dimming controls



DIGITAL GREENHOUSE HS-3000 FULL SPECTRUM LED GROW LIGHT

OPERATION RECOMMENDATIONS

Light Coverage and Hanging Height Recommendations

Coverage and canopy light intensity levels can be adjusted by simply raising or lowering the light (additional hanging equipment may be required). For best results, position the light between 18" and 24" above the plant canopy according to the plant growth stage:

24" Above canopy | lower canopy intensity, best for seedlings & young vegetative plants | up to 4' x 4' coverage

18" Above canopy | higher canopy intensity, best for flowering plants | up to 3' x 3' coverage

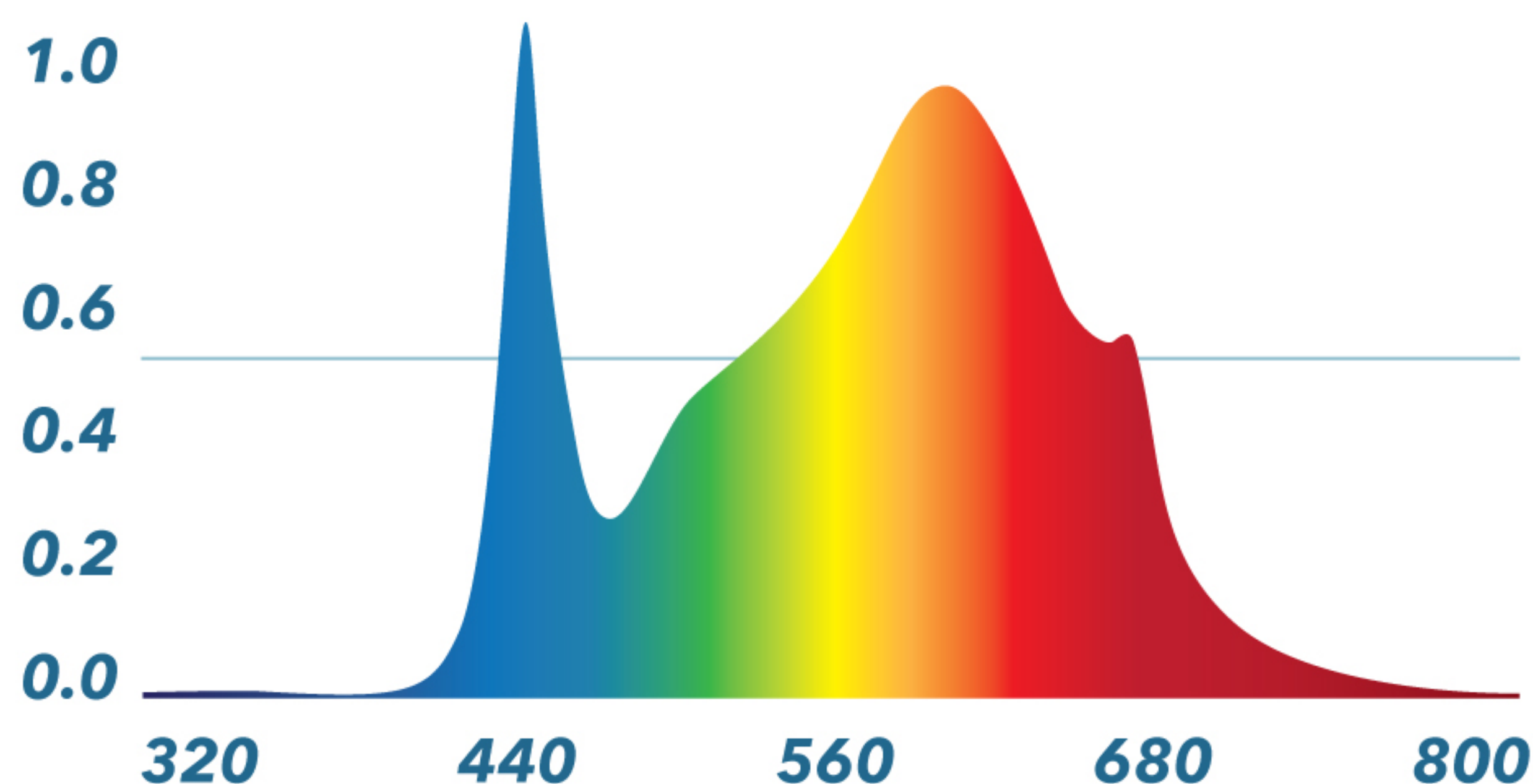

24" ABOVE CANOPY



18" ABOVE CANOPY



395	505	607	619	600	507	392
525	956	944	1033	950	952	537
640	974	1289	1368	1281	979	648
717	1094	1397	1489	1399	1091	719
631	972	1290	1371	1289	979	639
535	948	941	1038	944	955	535
396	517	599	616	603	508	407

<599 PPFD

600-899 PPFD

900-1199 PPFD

>1200 PPFD

LIGHTING CYCLE TIPS

Lighting cycles (lights-on/lights-off durations) are essential for achieving proper growth and good production. While optimal light cycles can vary among plant species/strains, the following general 24-hour schedules will work great for most plants:

VEGETATIVE STAGE

ON: 18HR

OFF: 6HR

Seedlings & Vegetative-Stage plants: 18 hours lights-on, 6 hours lights-off - simulates longer daylight periods of spring/summer to maximize vegetative growth.

FLOWERING STAGE

ON: 12HR

OFF: 12HR

Flowering-Stage Plants: 12 hours lights-on, 12 hours lights-off - simulates shorter daylight periods of late-summer/autumn to encourage flower growth and development.

SAFETY INFORMATION

- Intended for indoor use only.
- Do not operate in extreme heat or cold conditions
- Caution: To protect eyes, do not look directly at LEDs
- Disconnect from power source before handling
- Caution: Driver may be hot to the touch. Use appropriate protective gloves or allow to cool before handling.